

Technical data sheet

DSP 9911-AH-24V dosing pump

The DSP 9911-AH-24V is a high quality pump with a DC motor. It is reliable and has a long service life.

Features:

- Proven rotor design with spring-loaded rollers
- Double ball-bearing rotor drive shaft
- Gearing specially optimised for the peristaltic pump



Performance data

Flow rate*: 150 ml/min

Max. back pressure*: 1.5 bar

Duty cycle: 50%/h

* determined with water at 20 °C

Electrical data

Operating voltage: 24 V DC

Input current: 200 mA

Input power: 4.8 VA

Protection class: IP 00

Mechanical data

Dimensions: 64 x 99 x 112 mm

Weight: 260 g

Tube connections: 6 x 2 mm or 6 x 3 mm (grommet);
Optionally 5 x 1.5 mm (screw fitting) or
4 x 1 mm (compression fitting)

Ambient conditions

Ambient temperature range:
Environmental stress:

+5 ... +50 °C
Conforms to DIN EN 60068-2-38

Dimensions

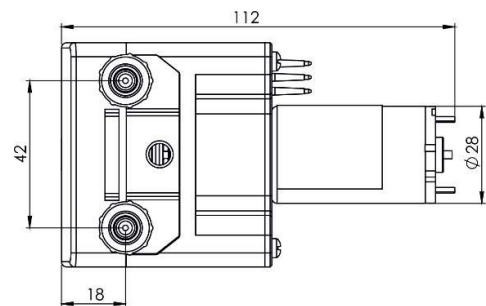
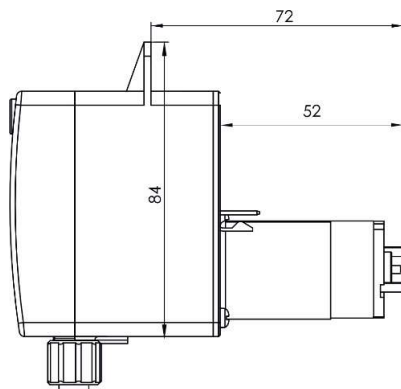
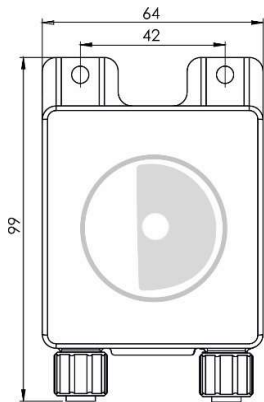

The DSP 9911-AH-24V dosing pump is an OEM pump for integration into machinery and equipment. Subject to quantity ordered, the pump can be customised.

The following parameters can be defined:

- Flow rate (via pump tube)
- Speed (via rear speed control board)
- Pump tube material and dimension
- Tube connection